

Metric Backing FLANGE *Full* thickness

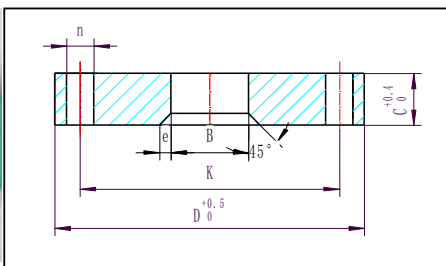
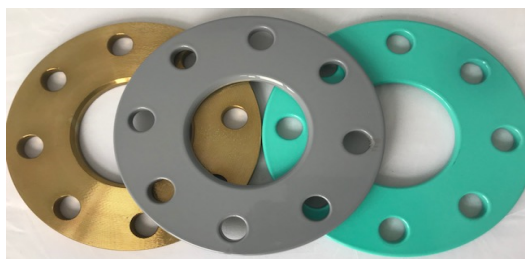

3M™ Scotchkote™ 206N - Green (data sheets available)

MILD STEEL A105 PLATE BACKING FANGES - PLFF PN16 - FULL THICKNESS

| SIZE | ITEM | D = OD | B = ID | C = THK | 45% | K = PCD | Bolt HOLE | NO OF HOLE |
|-------|-------|--------|--------|---------|-----|---------|-----------|------------|
| DN80 | 62200 | 200 | 90 | 20 | 3 | 160 | 18 | 8 |
| DN100 | 62201 | 220 | 110 | 22 | 4 | 180 | 18 | 8 |
| DN125 | 62202 | 250 | 136 | 24 | 4 | 210 | 18 | 8 |
| DN150 | 62203 | 285 | 161 | 24 | 5 | 240 | 22 | 8 |
| DN200 | 62204 | 340 | 212 | 26 | 6 | 295 | 22 | 12 |
| DN250 | 62205 | 405 | 262 | 29 | 6 | 355 | 26 | 12 |
| DN300 | 62206 | 460 | 313 | 32 | 6 | 410 | 26 | 12 |
| DN350 | 62207 | 520 | 364 | 35 | 8 | 470 | 26 | 16 |
| DN400 | 62208 | 580 | 418 | 38 | 8 | 525 | 30 | 16 |
| DN450 | | 640 | 470 | 42 | 8 | 585 | 32 | 20 |
| DN500 | | 715 | 520 | 46 | 8 | 650 | 33 | 20 |

Plascoat PPA 571 - Grey (data sheets available)

MILD STEEL A105 PLATE BACKING FANGES - PLFF PN16 - FULL THICKNESS

| SIZE | ITEM | D = OD | B = ID | C = THK | 45% | K = PCD | Bolt HOLE | NO OF HOLE |
|-------|------|--------|--------|---------|-----|---------|-----------|------------|
| DN80 | | 200 | 90 | 20 | 3 | 160 | 18 | 8 |
| DN100 | | 220 | 110 | 22 | 4 | 180 | 18 | 8 |
| DN125 | | 250 | 136 | 24 | 4 | 210 | 18 | 8 |
| DN150 | | 285 | 161 | 24 | 5 | 240 | 22 | 8 |
| DN200 | | 340 | 212 | 26 | 6 | 295 | 22 | 12 |
| DN250 | | 405 | 262 | 29 | 6 | 355 | 26 | 12 |
| DN300 | | 460 | 313 | 32 | 6 | 410 | 26 | 12 |
| DN350 | | 520 | 364 | 35 | 8 | 470 | 26 | 16 |
| DN400 | | 580 | 418 | 38 | 8 | 525 | 30 | 16 |
| DN450 | | 640 | 470 | 42 | 8 | 585 | 32 | 20 |
| DN500 | | 715 | 520 | 46 | 8 | 650 | 33 | 20 |

MILD STEEL A105 ZINC PLATED

MILD STEEL A105 PLATE BACKING FANGES - PLFF PN16 - FULL THICKNESS

| SIZE | ITEM | D = OD | B = ID | C = THK | 45% | K = PCD | Bolt HOLE | NO OF HOLE |
|-------|-------|--------|--------|---------|-----|---------|-----------|------------|
| DN80 | 26170 | 200 | 90 | 20 | 3 | 160 | 18 | 8 |
| DN100 | 26171 | 220 | 110 | 22 | 4 | 180 | 18 | 8 |
| DN125 | 26172 | 250 | 136 | 24 | 4 | 210 | 18 | 8 |
| DN150 | 26173 | 285 | 161 | 24 | 5 | 240 | 22 | 8 |
| DN200 | 26174 | 340 | 212 | 26 | 6 | 295 | 22 | 12 |
| DN250 | 26175 | 405 | 262 | 29 | 6 | 355 | 26 | 12 |
| DN300 | 26176 | 460 | 313 | 32 | 6 | 410 | 26 | 12 |
| DN350 | 26177 | 520 | 364 | 35 | 8 | 470 | 26 | 16 |
| DN400 | 26178 | 580 | 418 | 38 | 8 | 525 | 30 | 16 |
| DN450 | | 640 | 470 | 42 | 8 | 585 | 32 | 20 |
| DN500 | | 715 | 520 | 46 | 8 | 650 | 33 | 20 |

** We cannot guarantee the pressure values listed as they are for general information and to be used as a guide only.

**IMPORTANT: The pressure values indicated are as a GUIDE only, and Neumo UK Ltd accept no liability to any loss or damage caused by using this information.